

GRAVEYARD EXTENSION

EXISTING GRAVEYARD

Agreed Oct. 18, 1930
to leave out rows
105-116 and
1-12 until further
notice
also 22, 23, 135, 184, 210

GRAVEYARD

Also additional
graves made on
land of Oak Hill
and the present
to be shown on
plan.

Extra row inserted, I believe
A. J. Foster
Oct 1976.

Church is in this direction

Old part of graveyard in front of church

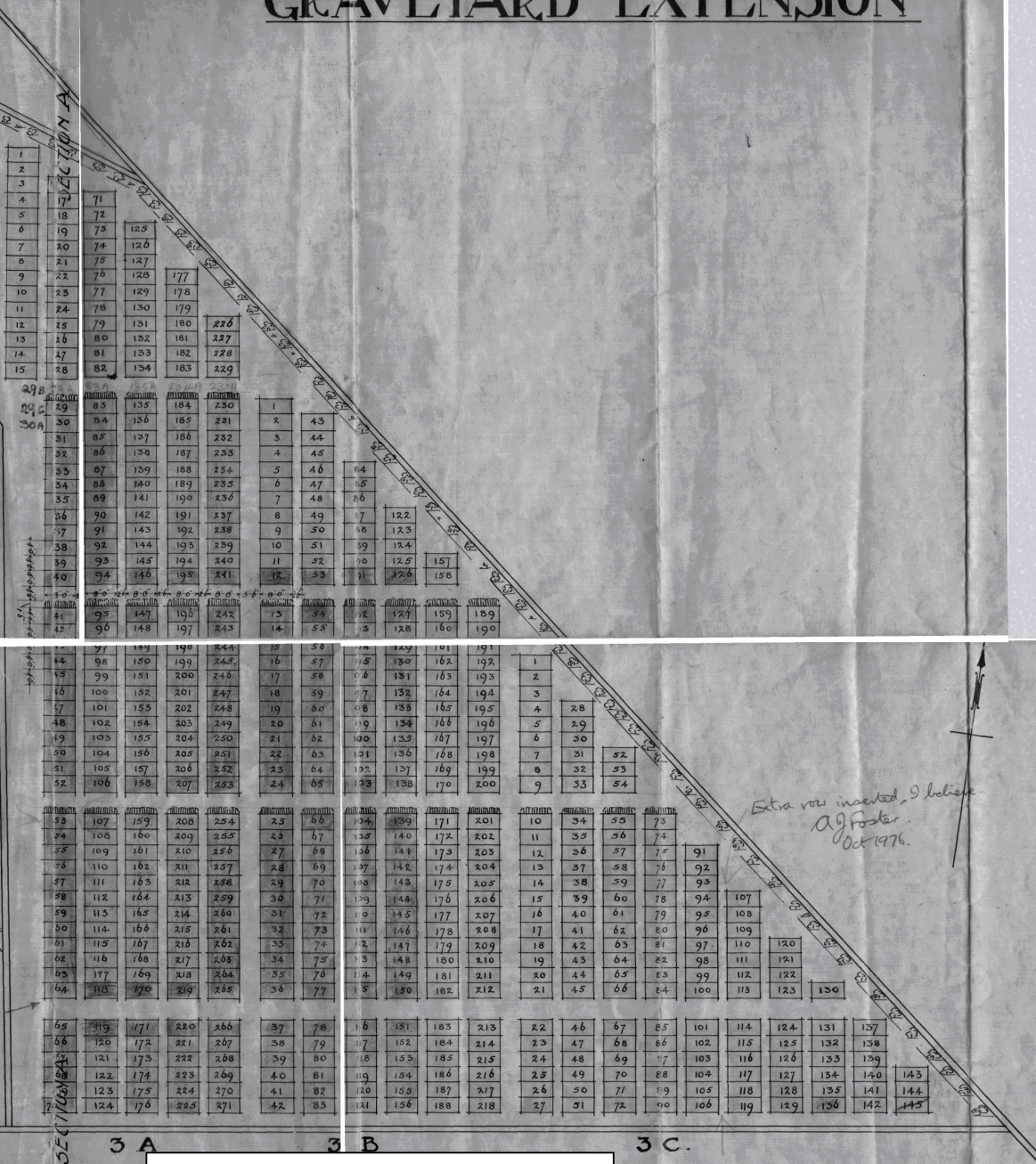

118A 170A 247A 265A
118B 170B 247B 265B

3 A 3 B 3 C